

Environmentally-friendly insulation system
made from natural wood fibres



NEW:
Delivery widths up to 260 mm



| APPLICATION AREAS

For installation under window sills as
a secondary weathering protection



| MATERIAL

Hydrophobic Woodfibre board with
directly applied, diffusion open and
weather repellent membrane

- Reliable protection from Wind driven Rain and Snow
- Robust safety for window connections in timber construction
- Ideal for use in combination with STEICO*protect* ETICS
- Particular easy to install
- Available in standard lengths and widths

For more information please visit our website at www.steico.co.uk

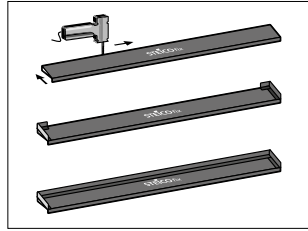
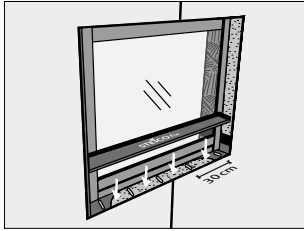

| DELIVERY FORMATS STEICO*fix*

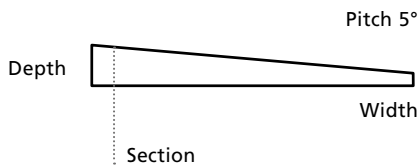

Width [mm]	Thickness [mm]	Length [mm]	Pieces / Pack	lm / Pack
100	20	1,350	25	33.75
140	20	1,350	25	33.75
180	20	1,350	25	33.75
260	30	1,350	25	33.75

| TECHNICAL VALUES STEICO*fix*

| STORAGE/TRANSPORT

STEICO*fix* should be stored dry and level and protected from UV degradation.

| WEATHERING

STEICO*fix* can be left exposed externally for up to 4 weeks. Weathering beneath the membrane should be avoided. Connection at joints with STEICO*multi tape*.

Insulation wedge thickness in [mm]	20	30♦
Length in [mm]	1,350	
Pitch	5°	
Fire class in accordance with EN 13501-1	E	
Declared Thermal Conductivity λ [W/(m*K)]	0.047	
Equivalent air thickness layer in [m] s_d -Wert	0.06	0.09
Water pressure resistance in [cm] Water column	≥ 400	
Raw material	woodfibre, polyurethane resin, paraffin, membrane	

♦Insulation wedge thickness should be agreed with the window manufacturer



Operating site certified according to ISO 9001:2015