

UdiCLIMATE® SYSTEM

The interior insulation system with integrated climate chambers

THE NEW WAY TO
BUILD – LIGHT & EASY

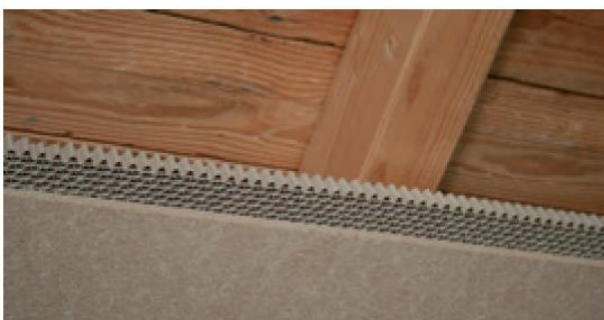

UdiCLIMATE® is applicable as an underside, roof insulation board or dry lining layer for walls

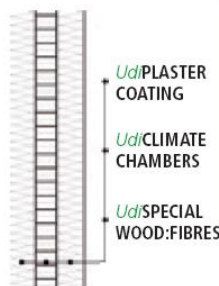

Up to a 50%
reduction in
the sound
energy

UdiCLIMATE® is an extremely versatile interior construction board that can be directly plastered. It can be used as an internal, rafter insulation and for ceiling areas as well as on stud walls and substructures. The board is free from harmful substances and is easy to install. The three interconnected capillary-active insulating layers, consisting of a layer of almost stationary air columns in a special, climate-chamber, cell structure enclosed within two wood fibre layers, harmonize perfectly.

This sandwich structure guarantees flexural rigidity without any warping of the surface when used with plasters or blown-in insulation. In a test report, the airborne noise measurements before and after the installation show a halving of the incident sound energy, despite the slim construction. UdiCLIMATE® is the natural alternative to traditional cladding options.

→ The advantages

- Highly insulating despite its slim construction
- easy one-man installation
- can be coated with loam/clay and lime plasters
- maintains the room climate and absorbs cold radiation
- up to 80 cm centre-lines with offset mounting pattern

Technical Data UdiCLIMATE® SYSTEM

Format	115 x 75 cm
Insulation thickness	30 mm
Coefficient of thermal resistance R	0.604 m ² KW
Weight per board	ca. 4.65 kg
Vapour diffusion resistance	5
Apparent density wood-fibre layer	210 kg/m ³
Euroclass fire rating DIN EN 13501-1:	E
Vapour retardation value with UdiFOUNDATION COAT	ca. 1 Meter

Test report: MFPA Nr. PB.4.2/16-154-1

Components:

- 66.0 % natural fibres from coniferous waste wood
- 31.0 % Kraft paper from natural wood
- 1.5 % Sodium silicate
- 0.5 % Marble dust and binding agent