

Environmentally friendly insulation system made from natural wood fibres

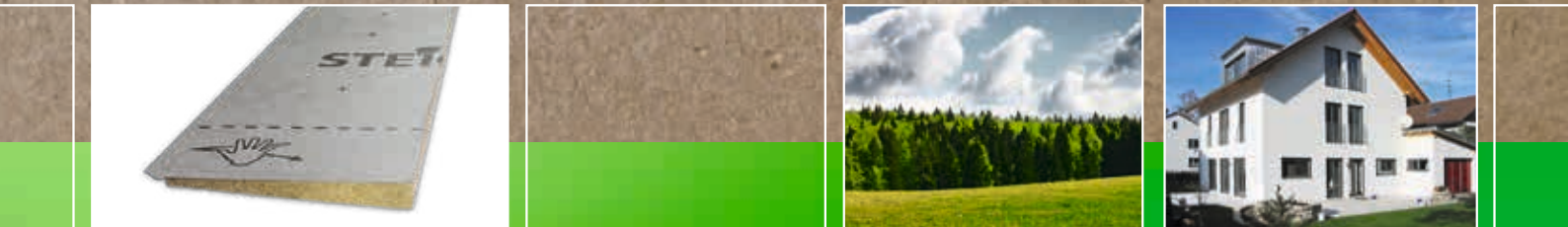

NEW:
Formats up to
260 mm



Woodfibre insulation wedge for window sills



Application areas

For installation under window sills as a secondary weathering protection

- Reliable protection from wind driven rain and snow
- Robust safety for window connections in timber construction
- Ideal for use in combination with STEICO*protect* ETICS
- Particular easy to install
- Available in standard lengths and widths
- Compatible with STEICO accessory materials

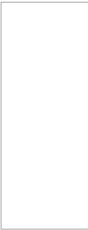
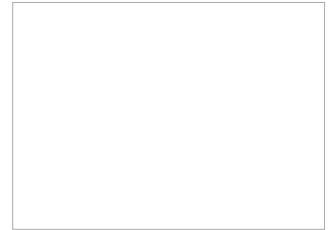
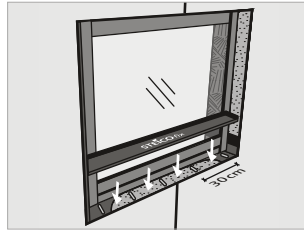
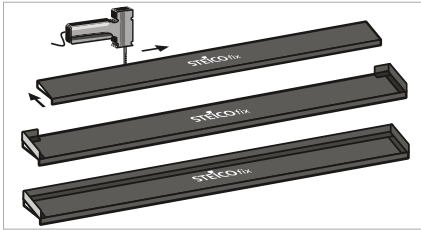

Delivery formats STEICOfix

Width [mm]	Thickness [mm]	Length [mm]	Pieces/Pack	m/Pack
100	20	1350	25	33.75
140	20	1350	25	33.75
180	20	1350	25	33.75
200	25	1350	25	33.75
260	30	1350	25	33.75

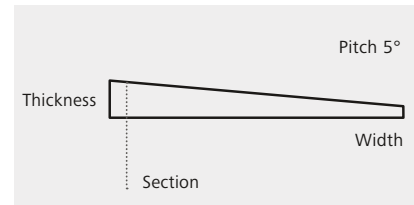

Technical values STEICOfix

Insulation wedge thickness in [mm]	20 ¹⁾	25 ¹⁾	30 ¹⁾
Length in [mm]	1350		
Pitch	5°		
Fire class according to EN 13501-1	E		
Declared Thermal Conductivity λ [W/(m*K)]	0.047		
Water vapour diffusion resistance value μ	7		
Water pressure resistance in [cm] Water column	≥ 4.000		
Raw material	woodfibre, polyurethane resin, paraffin, membrane		

Notes: STEICOfix should be stored dry and level and protected from UV degradation. STEICOfix can be left exposed externally for up to 4 weeks. Weathering beneath the membrane should be avoided. Connection at joints with STEICOmultipaper with split backing paper 20/40 mm. Hydrophobic woodfibre insulation board with bonded, diffusion open and water resistant membrane.

Quality Management
ISO 9001:2015

STEICO
engineered by nature

Your STEICO partner

www.steico.com