

UdiIN 2CM® SYSTEM

The quick and slim internal insulation system

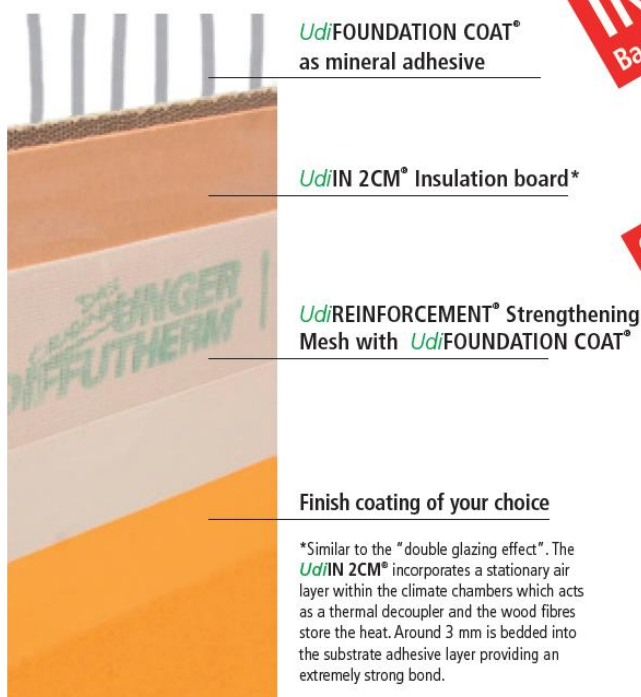

*Similar to the "double glazing effect". The **UdiIN 2CM®** incorporates a stationary air layer within the climate chambers which acts as a thermal decoupler and the wood fibres store the heat. Around 3 mm is bedded into the substrate adhesive layer providing an extremely strong bond.

INNOVATION
Based on 25 years of experience

- Quick
- Slim
- Warm

CLIMATE CHAMBERS



UdiIN 2CM® Insulation board*

Our interior insulation is not only simple and thereby cost-efficient to install but **UdiIN 2CM®** also provides decisive energy-saving benefits, especially in rooms that are only sporadically used and heated (assembly halls, residential rooms etc.).

The internally insulated rooms can be heated very quickly as the solid external walls must not be warmed along with the room. This factor is often overlooked and offers huge potential for saving energy.

In a test measurement on a building with traditional brick walls, the U-value improved from 1.3 before to 0.5 after the installation.

- Quickly installed without wall plugs
- Warm wall surfaces
- For every room where space is limited
- Increases the surface temperature
- Bridges cracks
- The sensation of cold disappears

→ Applications

- Listed buildings
- Private houses, apartments
- Schools, hospitals, kindergartens
- Community and assembly rooms
- Holiday homes, offices and many more

→ The advantages

- Easy installation
- Cost-saving attachment and fixing
- Sporadically used rooms warm up very quickly
- Perceptibly warmer exterior wall surfaces in winter
- Helps to save energy
- Reduces noise pollution within buildings
- Reduces e.g. the U-value of a sandstone wall by half!
- Impedes mould growth
- No restrictions in the choice of finishing coating

Of course, this principle can also be applied to ceilings and internal roof slopes in need of renovation.

For interior construction

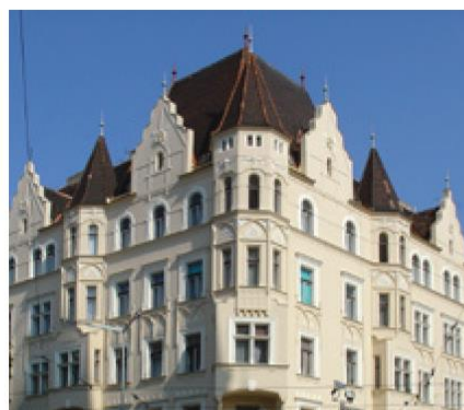

This sight of this beautiful façade has been retained thanks to **UdiIN 2CM®** internal insulation

Technical data:

Thermal conductivity Design value λ : 0.070 W/mK
 Apparent density wood fibre: 210 kg/m³
 Thickness: 23 mm (3 mm in the adhesive bed)
 Format: 115 x 75 cm
 Euroclass fire rating - wood fibre as per DIN EN 13501-1: E
 Waste Code as per EWC-Code: 030105, 170604
 Wood fibre manufacture and conformity control as per DIN EN 13986